



Mining  
Remediation  
Authority



# Camberwell Drive Ashton-under-Lyne

Residents Meeting  
27 March 2025

# Overview

- Project Progress
- Ground Investigations
- Utility Update
- Remediation Solution
- Phases of Work
- Logistics Plan
- Time Scales
- Customer Support



# Project Progress

- All outstanding site investigation works have been successfully completed
- The previous proposal is no longer viable due to ground conditions
- This has presented an opportunity to reassess the remediation options available
- MRA have complied with 3 x separate utility processes and have processed payment. Now awaiting start dates
- Ground Monitoring ongoing and is showing no noticeable movement which would cause concern
- Temporary car park and site clearance works
- Brick course and drainage surveys completed



# Ground Investigations



The Site Investigation was undertaken between 7 and 29 January 2025.

Eight cable percussion boreholes were undertaken to depths of between 7.4m to 41.7mbgl.

Seven CPT boreholes were undertaken to depths of between 2.7m and 28.1mbgl.

## Laboratory Testing

Fine grained soils (clay/silt) not conducive to permeation grouting

Presence of water at the base of the soil deposits not conducive to permeation grouting

Permeation Grouting is unlikely to be successful in these conditions





# Existing Utilities

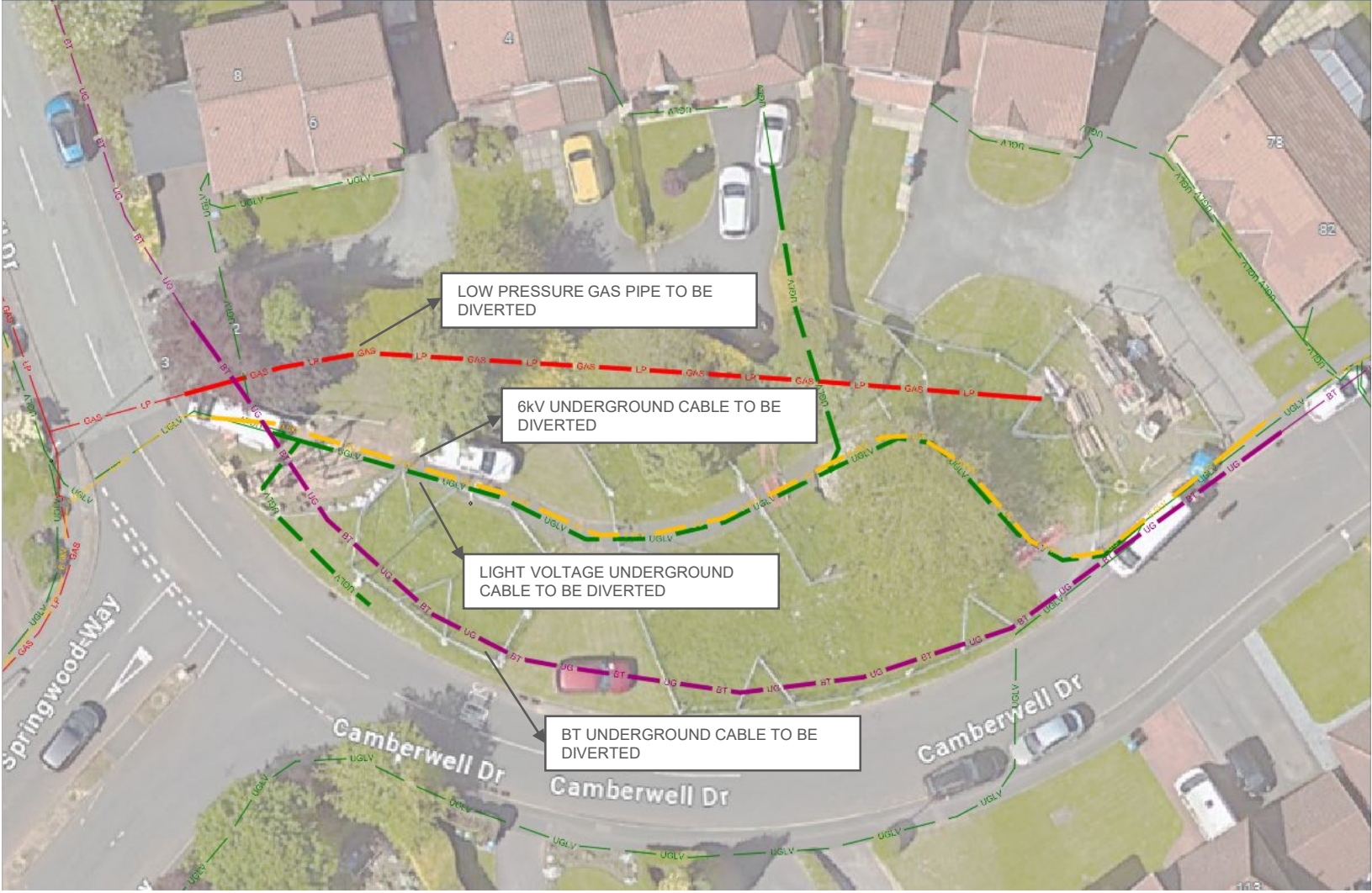

# Utility Diversions

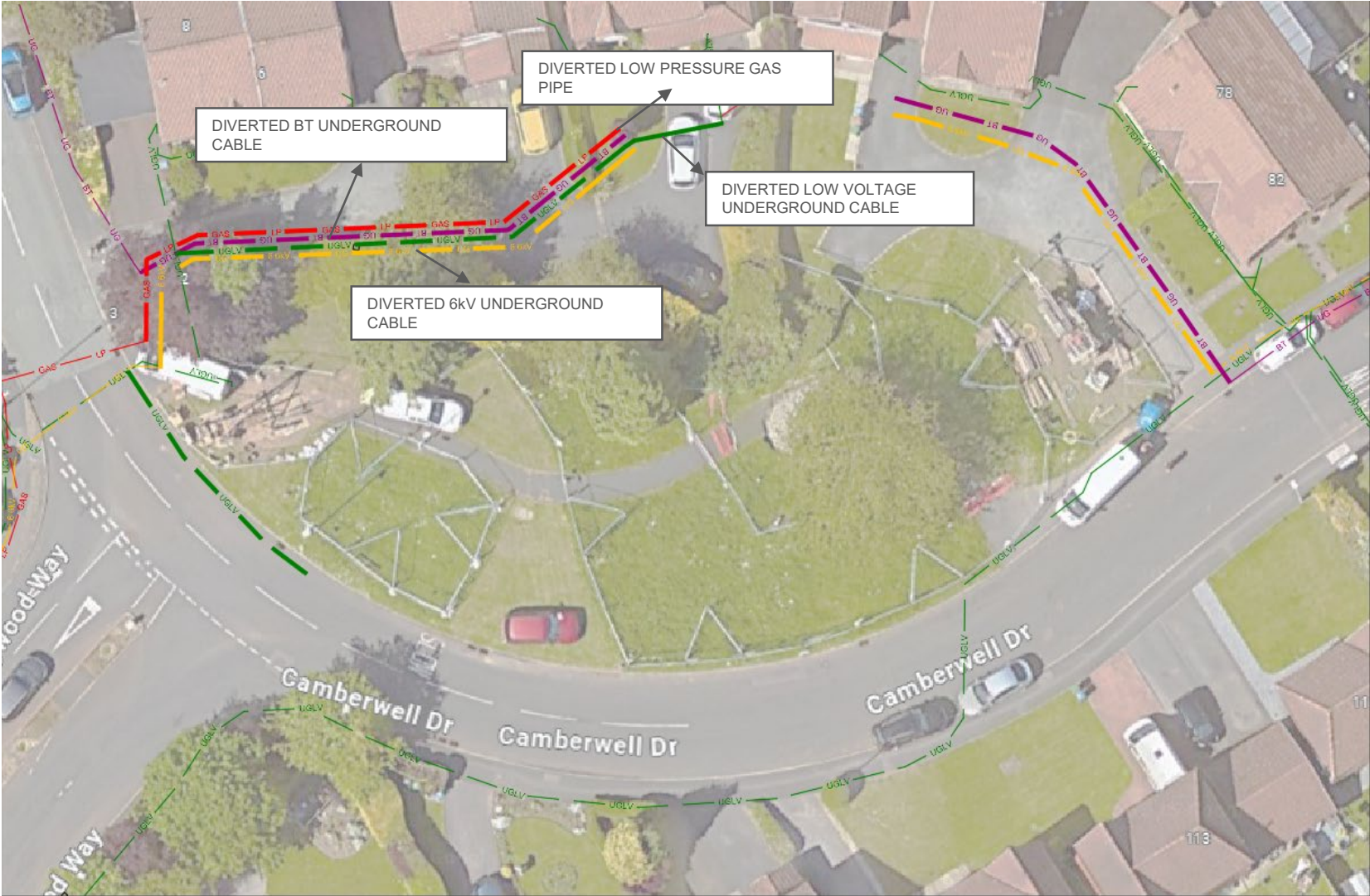



# Remediation Solution



## Capping and Managing the Mine Shaft

- Investigate the source of the problem, which we believe to be the mineshaft
- Stabilise the mine shaft and collapsed ground to a depth of 60m
- Construct reinforced concrete cap which will be constructed on piles
- Reinstatement
- Ground stability monitoring

## Constraints

- Maintaining Public Services
- Avoiding road closures
- Constrained site and access
- Utilities
- Deep soils (40m)
- Mine shaft (426m)
- Hydrogeology

# Platform Installation

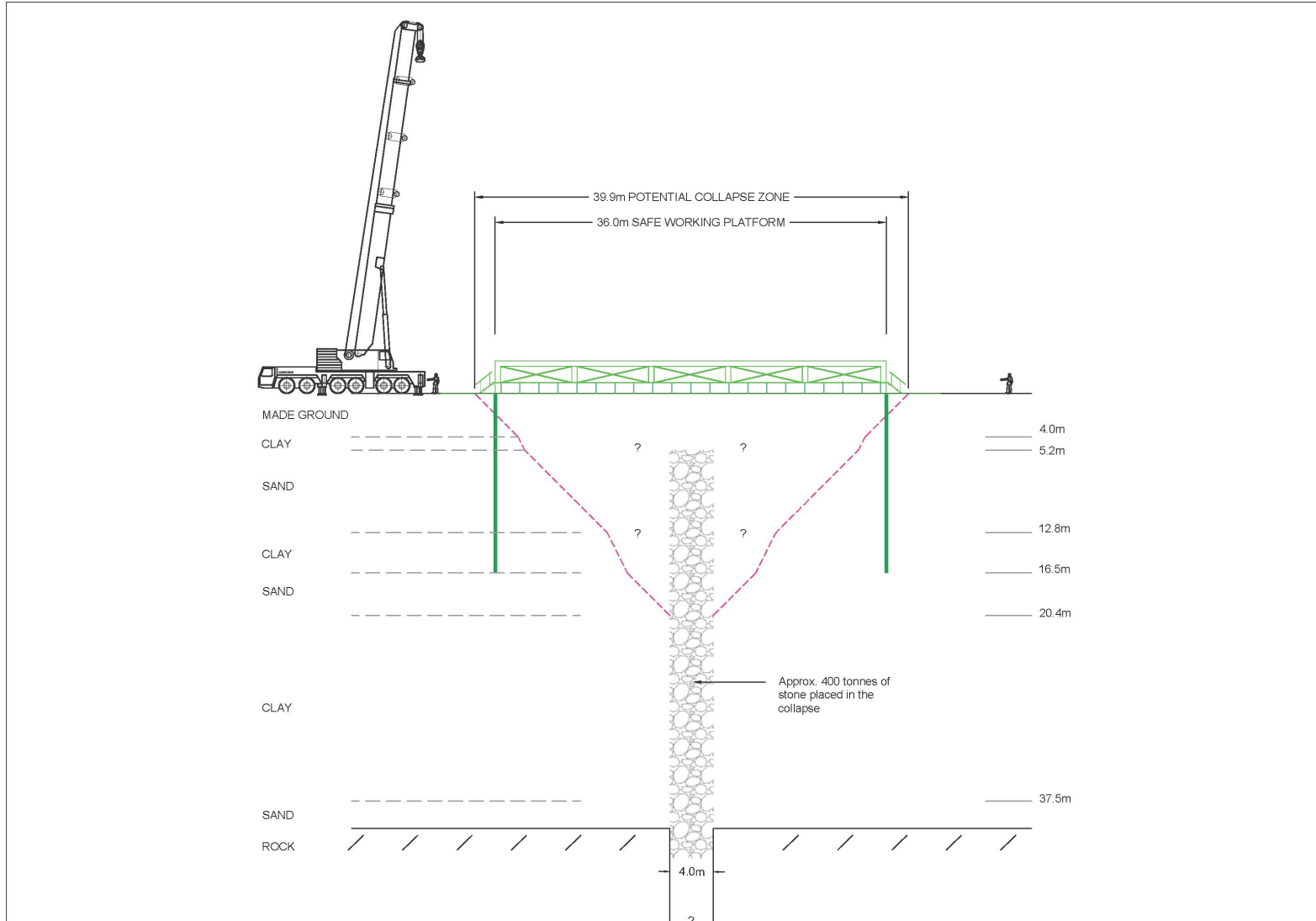

- Safe working platform required
- Piled foundations required due to ground conditions
- Piled foundations will be installed
- Installation of the safe working platform 1 week localised closure of Camberwell Drive estimated
- Piles will be sacrificial and cut-off 2m below ground surface on completion of all works



# Platform Installation





# Shaft Fill Investigation and Stabilisation

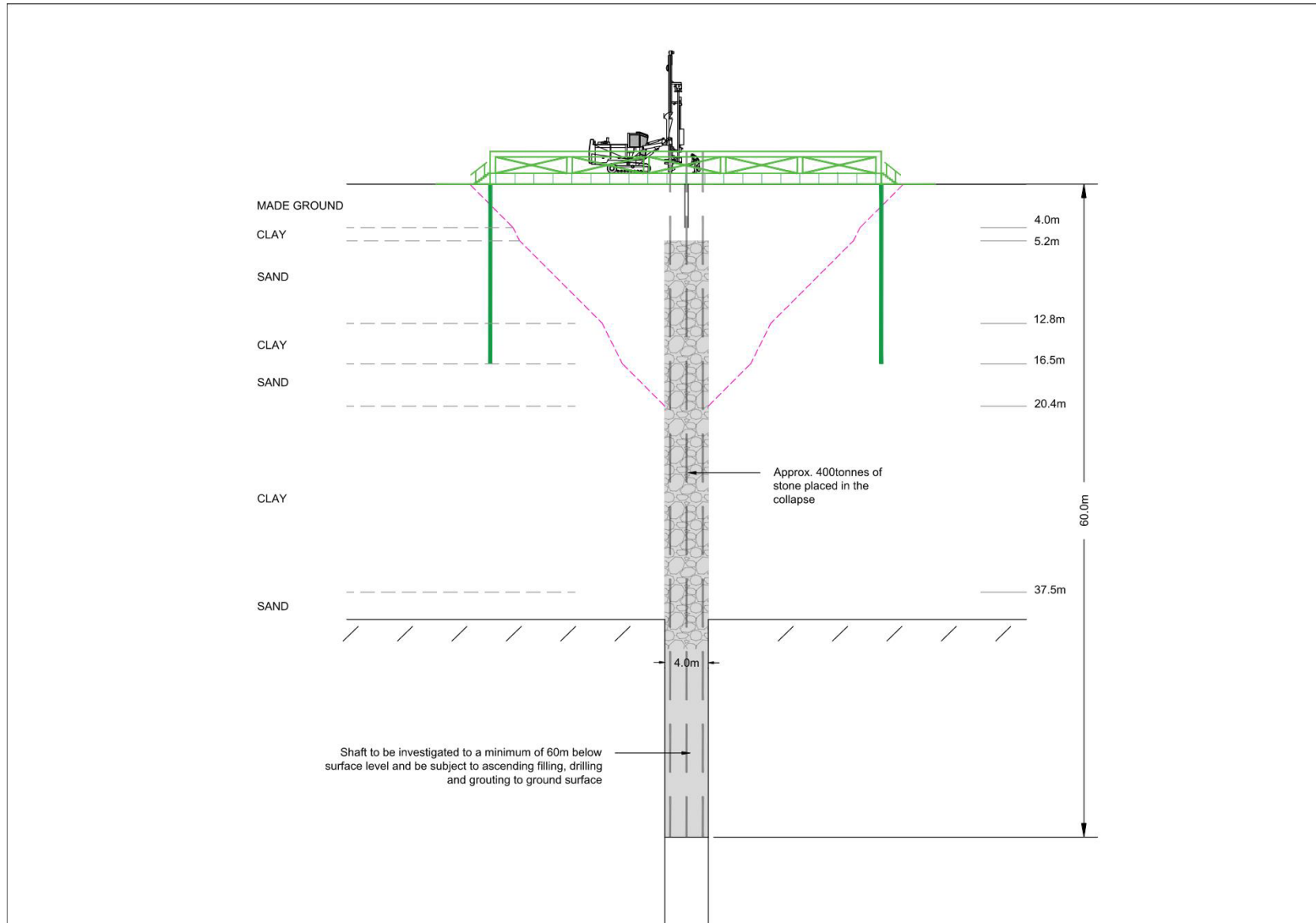

Vertical investigatory holes to locate the shaft and investigate the collapse

Shaft to be injected with grout from 60m to 5m

Estimated 5No. Primary injection holes and 2 Secondary holes

Grout plant to be located within the compound in the public open space to the south of Camberwell drive

# Ground Stabilisation

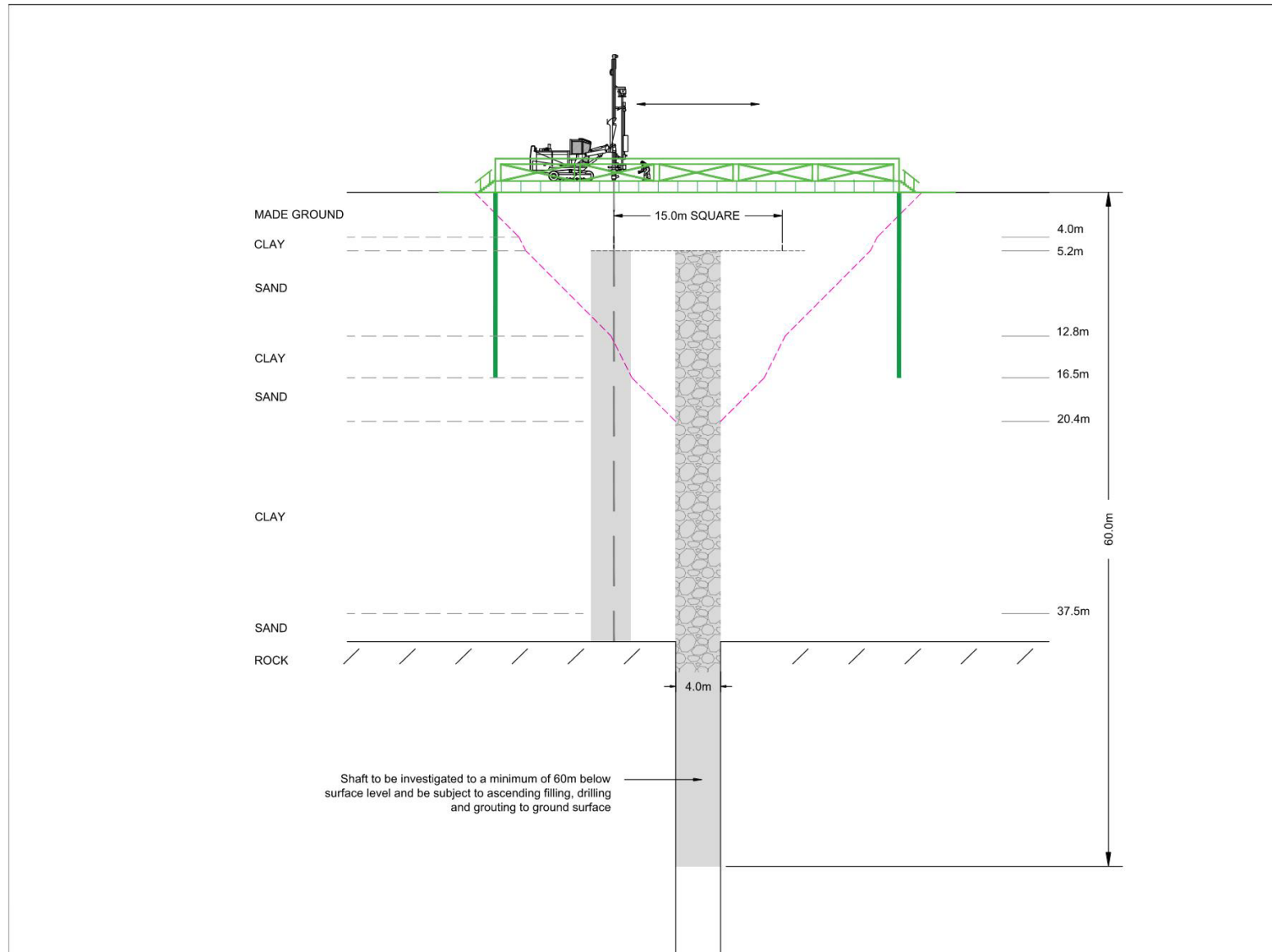

On completion of the shaft grouting work, grouting of the collapsed ground around the shaft will commence



# Ground Stabilisation and Instrumentation

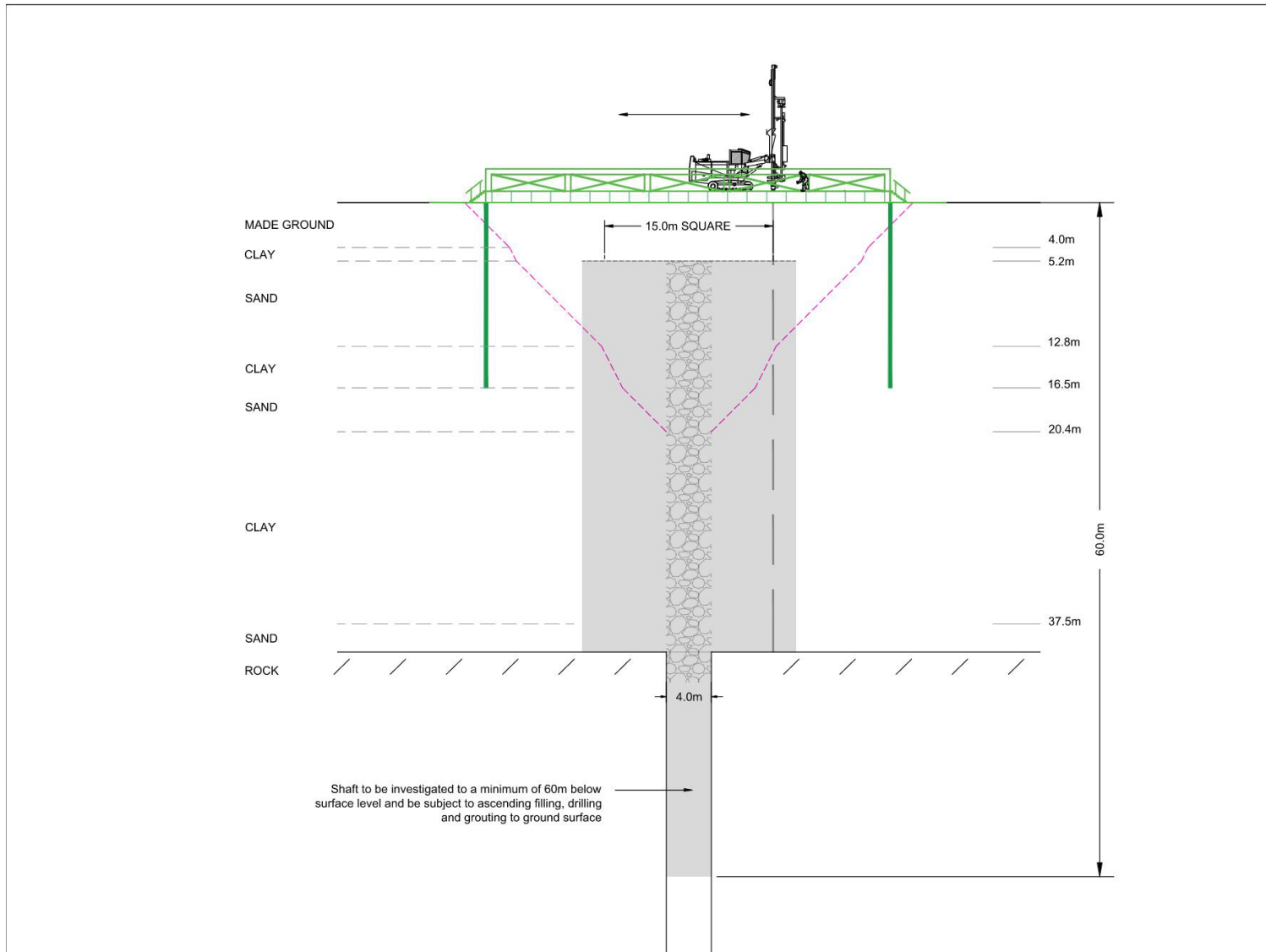

- Repositions of the safe working platform will be required to safely achieve the 15m square ground stabilisation
- Installation of subsurface monitoring equipment within the stabilised shaft
- Removal of safe working platform requiring temporary closures of Camberwell Drive

# RC Cap Piled Foundation

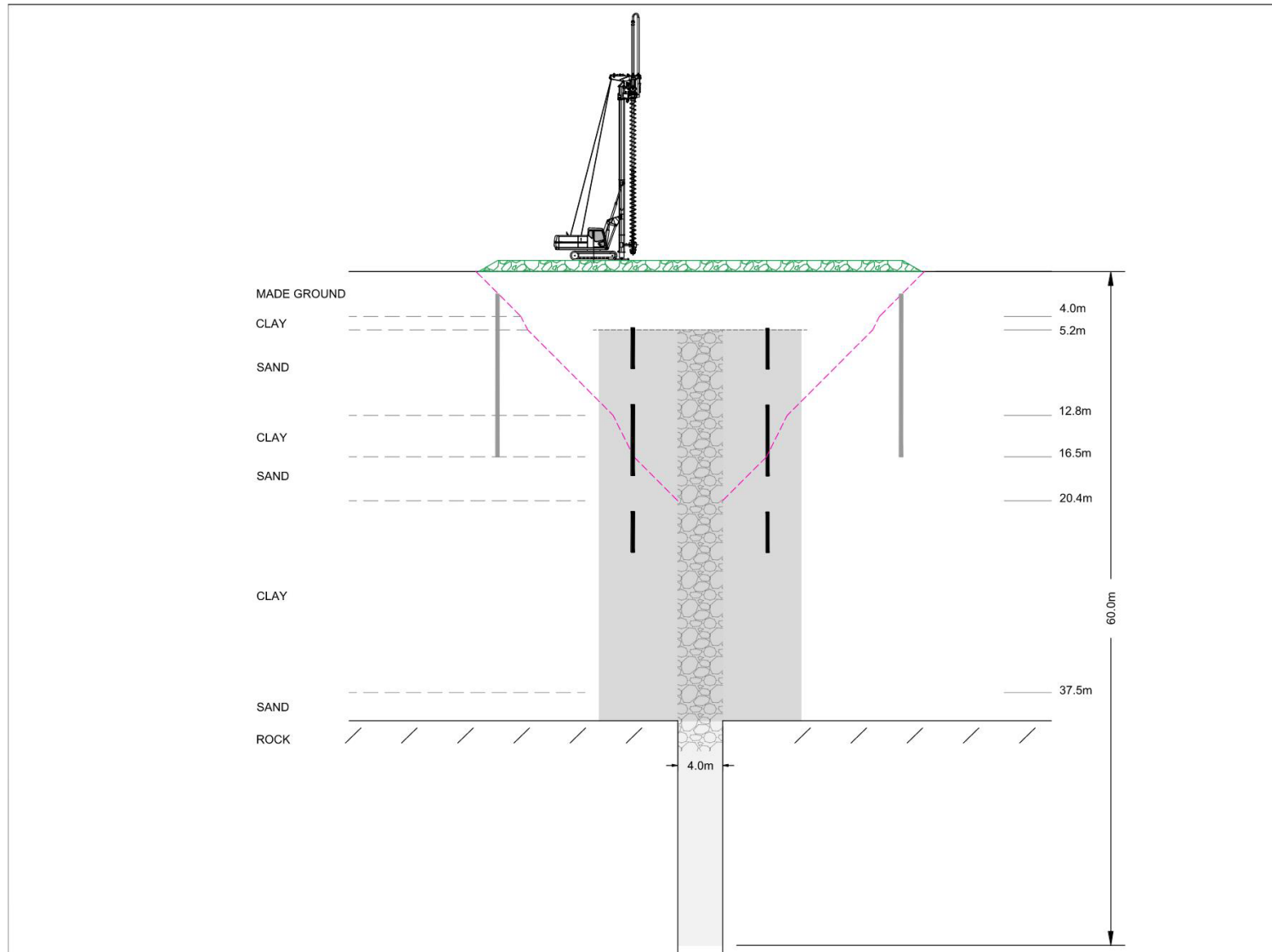

- Construction of a stone piling platform and access for the piling equipment
- Installation of piled foundations in readiness for construction of the proposed reinforced concrete (RC) shaft cap at 5.2m depth

# RC Cap Excavation

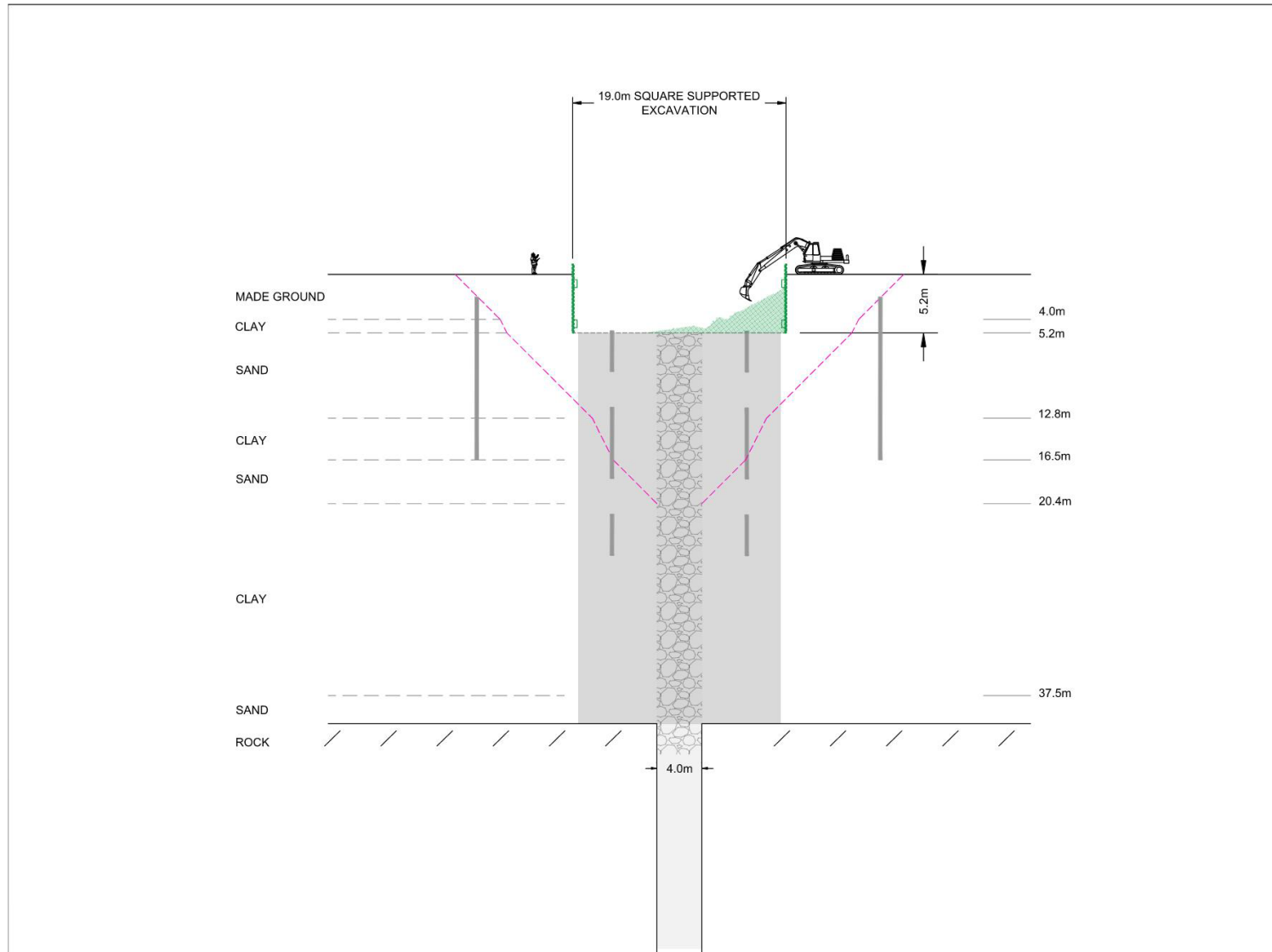

- Temporary works required for excavation to minimise disruption and disturbance
- 5.2m excavation in which the 15m square RC shaft cap will be constructed



# Reinstatement and Instrumentation

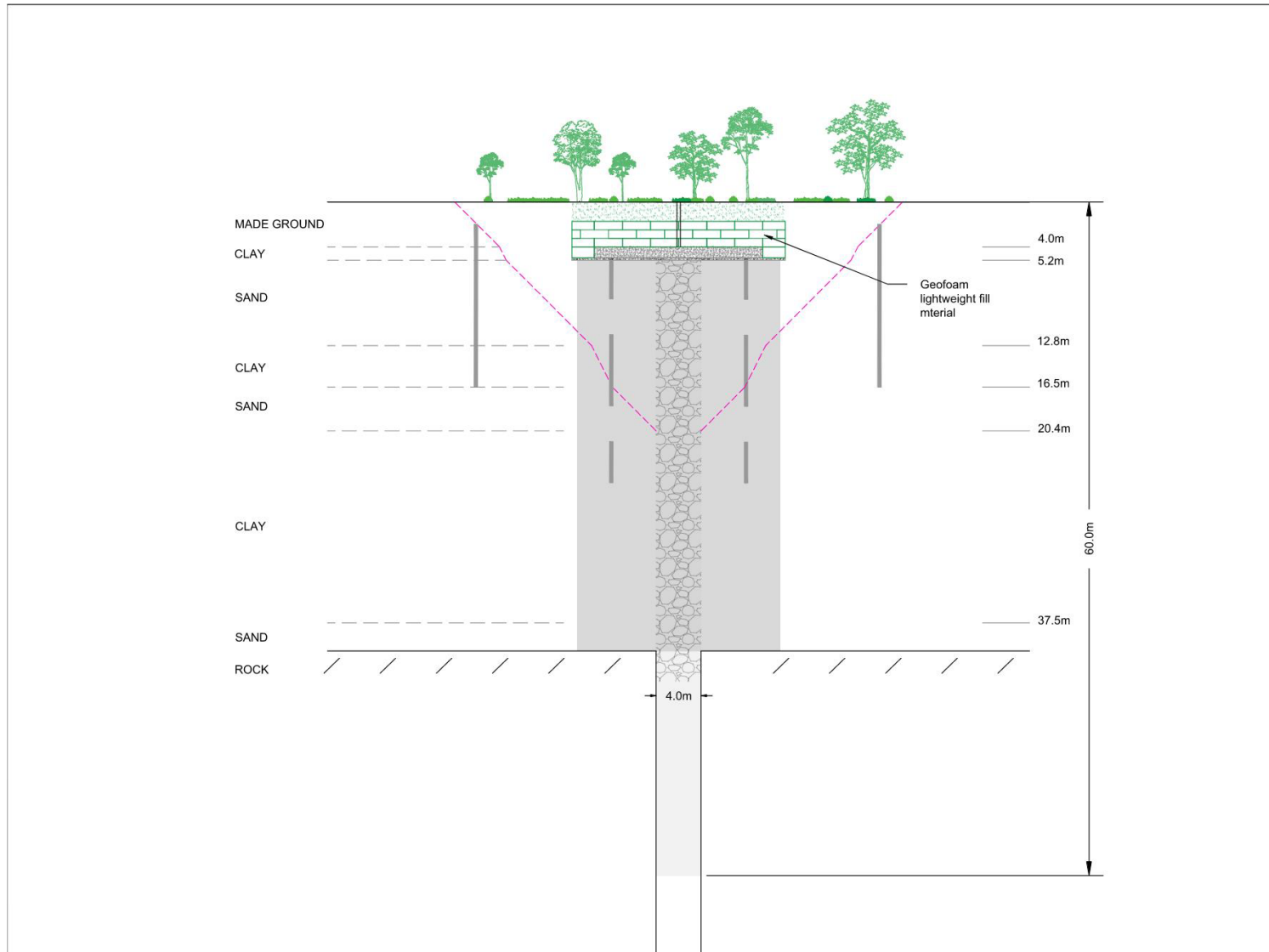







- Removal of the excavation supports whilst backfilling of the excavation with light weight polystyrene backfill blocks and soils
- Reinstatement of the ground surface  
Planting and footpath routes
- Remaining instrumentation to be installed providing ground and shaft monitoring in perpetuity

# Logistics Plan for Main Works (A)



## KEY

-  Approximate Position of Ground Collapse
-  Approximate Working Area
-  Temporary Traffic Management
-  Site compound, grouting plant, welfare
-  Temporary Residents Car Park Area
-  Deliveries
-  Grout / water lines



# Logistics Plan for Main Works (B)





# Logistics Plan for Works Area

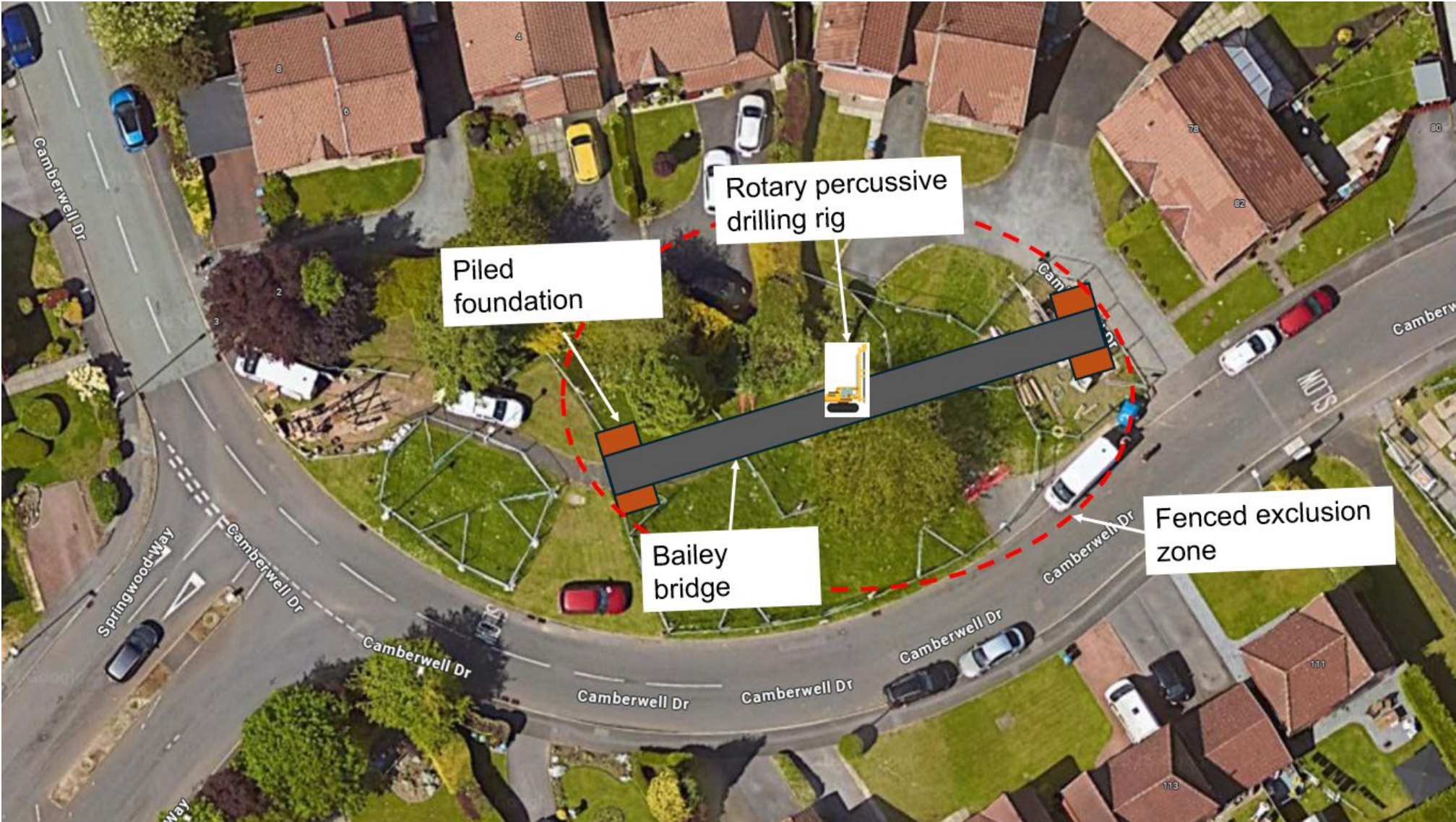



# Logistics Plan for Compound Area



# Timescales



## Work Phases

Utility Diversions works

ECO Site Clearance

Site Information and Approvals

Main Works – Shaft Remediation

Compound Area

Main Works – RC Shaft Cap

Monitoring Instrumentation

Reinstatement Works

- The current programme is planned to start in June 2025
- The planned completion date is October 2026 (16 months)
- Residents will be updated at the end of each phase of work by newsletter.



# Customer Support

- Community liaison officer
- Regular communications
- Monitoring during works
- Work with individual residents

## 24/7 incident hotline

0800 288 4242

## Email

customerservice@coal.gov.uk

**Online:** <https://www2.groundstability.com/location/camberwell-drive/>



Scan the code below to visit our Camberwell Drive website for more information on this project





# Questions