



The Coal  
Authority

# CON29M

## coal mining report

England and Wales

### 20m

reporting zone for  
recorded mine entries

### Up to 14

approved Law Society  
questions answered

### 99%

of reports are dispatched  
within 24 hours of ordering

### £100,000

insurance policy  
as standard

## Protect your clients and your reputation with our coal mining report

With one in four properties in England and Wales located in coalfield areas, our reports cover a significant portion of the property market. As a government body, our reports are trusted by legal professionals, insurers, property professionals, and major lenders across England and Wales.

### Key features



all known past, present  
and future coal mining  
risks



on or off coalfield  
confirmation



professional opinion  
on any coal mining  
related features that  
have been identified



concise glossary of key  
coal mining terms



further action  
recommendations



colour coded mining  
risk summary



direct links to follow-  
on reports for  
deeper insights

## Regular updates

If any changes to our data occur  
within 90 days of your report,  
we provide a new report free of  
charge

## Peace of mind

There's no one better placed to provide accurate information on coal mining related risks. Our reports include information from over 120,000 mine abandonment plans and 153,000 recorded mine entries across England and Wales, helping you to make informed decisions.



The Law  
Society

# Why trust a Coal Authority CON29M report?



## Updated to latest Law Society guidance:

Answers all official questions for residential and non-residential transactions



**OS mapping:** Allows us to clearly show the location of any mine entries or adits within 20 meters of the property or land boundary



## Clear, accessible information:

Glossary of key mining terms ensures easy understanding of technical aspects



**Access to further reports:** Direct links to follow-on reports for deeper insights, if required



**Property-specific details:** Provides information on past, present, or future mining activity, mine entries, coal mining subsidence, mine gas, and other hazards related to coal mining legacy, along with clear advice on obtaining a coal mining risk assessment



**Regular updates:** Information is updated on a daily basis. If any changes occur within 90 days of your report, we provide a new report free of charge



**Supports professional requirements:** Accepted by major lenders across England and Wales, ensuring no delays in property transactions

## Why we're great to work with

- **Trusted source:** The most reliable information on coal mining risks for property and land transactions
- **Non-departmental government body:** Provided by the Coal Authority, a statutory body with comprehensive and up-to-date information
- **Comprehensive coverage:** Includes information from over 120,000 mine abandonment plans and 153,000 recorded mine entries across England and Wales
- **Peace of mind:** Comes with an insurance policy of £100,000
- **Customer service:** Dedicated support team ready to assist with queries, same-day report returns and a comprehensive after service

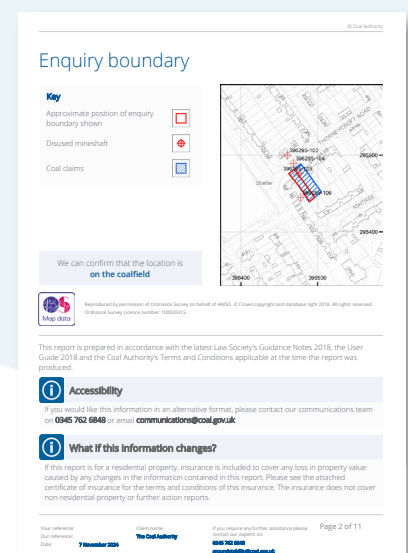

## Contact us

0345 762 6848 then select option 1  
[miningremediation@coal.gov.uk](mailto:miningremediation@coal.gov.uk)

For more product information, visit [www.groundstability.com](http://www.groundstability.com)